

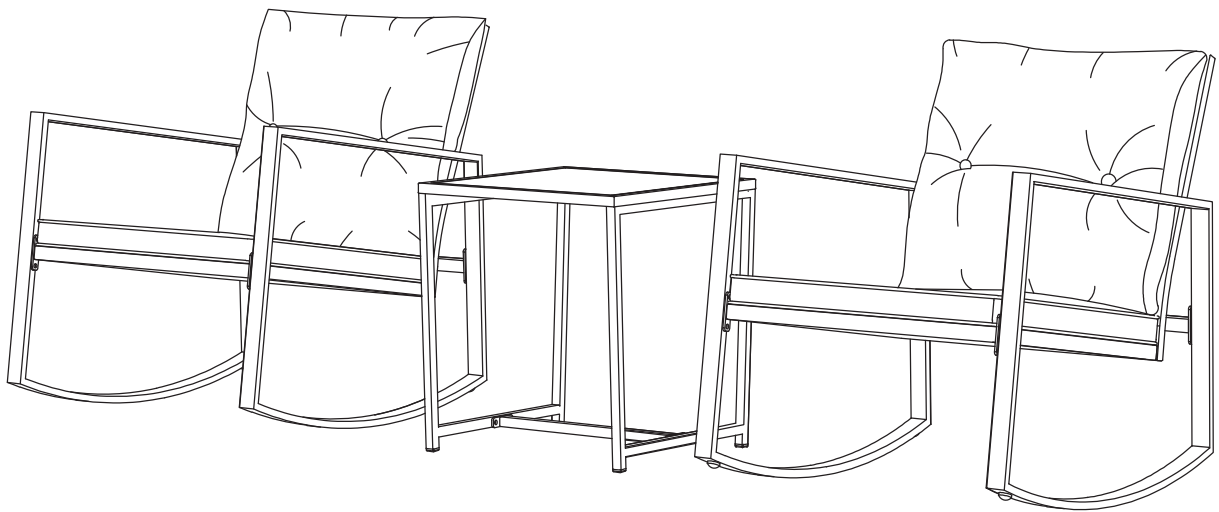

MOANA WICKER ROCKING BISTRO SET

ASSEMBLY MANUAL



KOZYARD LLC PRODUCTS

WWW.KOZYARD.COM

Care and warranty

- The weight capacity of this chair is 250 lbs.
- Clean the frame components and fabric with a mild soap solution, then rinse thoroughly. Avoid using bleach, acid, or any other solvents on either the fabric or frame components.
- For a comprehensive warranty policy, please visit www.kozyard.com. Be aware that warranty terms can change without prior notification.
- For the best performance and safety of your chair, inspect and tighten all bolts and fasteners regularly.

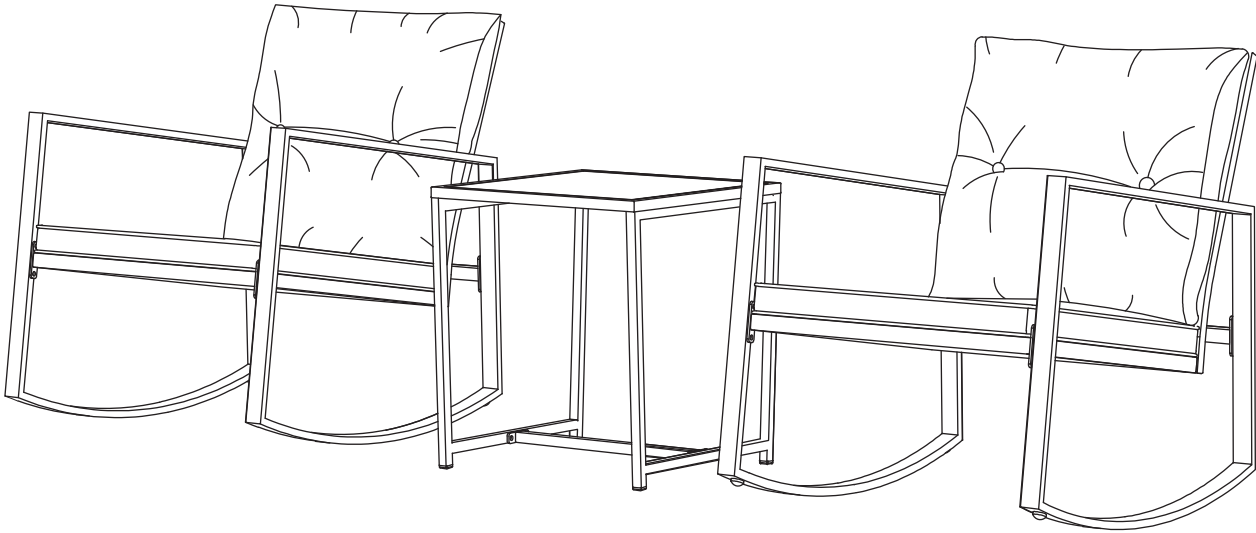

Assembly Instructions

- Prior to assembly, ensure that you lay out and identify all the parts listed in the parts list.
- Tighten all nuts and bolts securely. Hand-tighten all bolts before use. Avoid using power tools or applying excessive force during assembly and bolt tightening.
- If you encounter any difficulties during assembly or if any part is missing or damaged, please don't hesitate to contact our customer service team via email at info@kozyard.com or by calling our toll-free number at 866-355-0018.

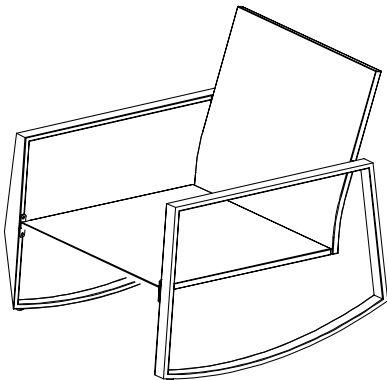

X2

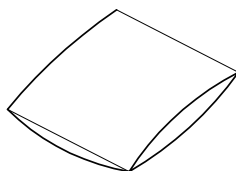
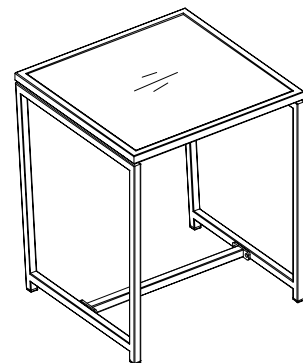

ASSEMBLY BAG



ROCKING CHAIR

(DO THIS TWO TIMES)

Item No.	Reference Image	Description	QTY
A		Seat Back	1pc
B		Seat Base	1pc
C1		Right Arm Rest	1pc
C2		Left Arm Rest	1pc
D		Seat Back Support	1pc
E		M6x35 Socket Head Cap Screw	4pcs
F		M6x20 Socket Head Cap Screw	8pcs
G		Flat Washer	12pcs
H		Screw Cover	12pcs
I		4-mm Allen Key	1pc

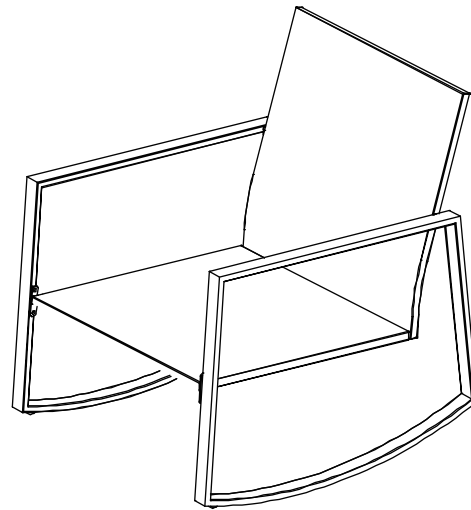

1. Attach the seatback (A) and the seat base (B) using an M6 x 35 socket head cap screw (E) with a flat washer (G) in two locations.

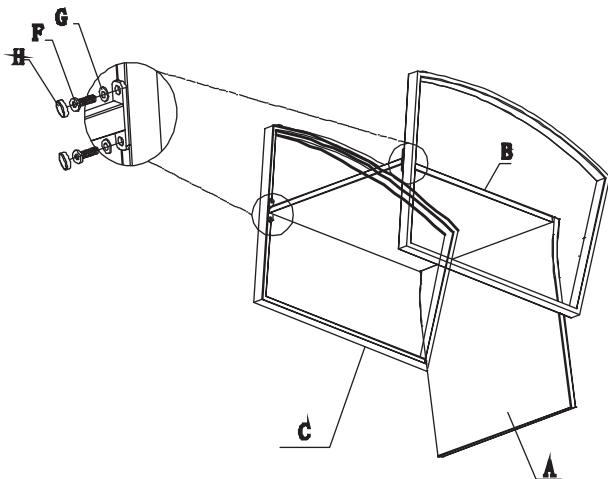
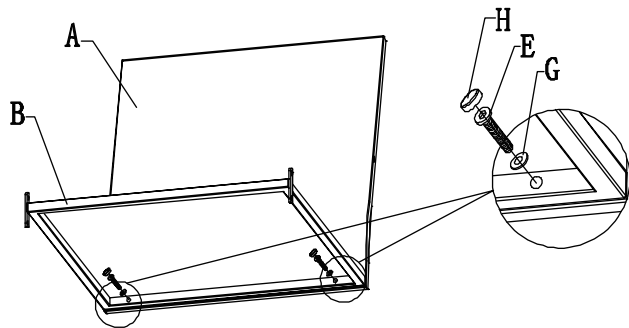

2. Flip the assembly upside down. Secure the armrests (C & D) to the seat base (B) using M6 x 20 screws (F) with a washer (G) at four loca-



ROCKING CHAIR (DO THIS TWO TIMES)

3. Flip the assembly back. Secure the seatback (A) using M6 x 35 screws (E) with a washer (G) in two locations.

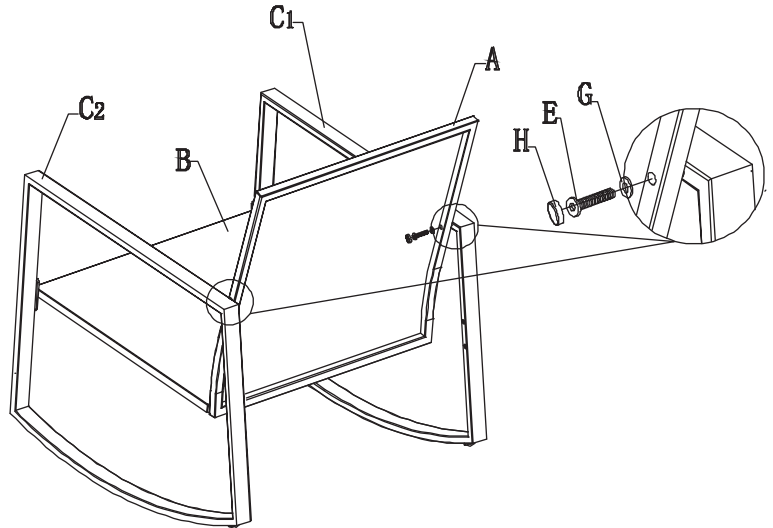

4. Attach the seat back support (D) using M6 x 20 screws (F) with a washer (G). Do this in four places.

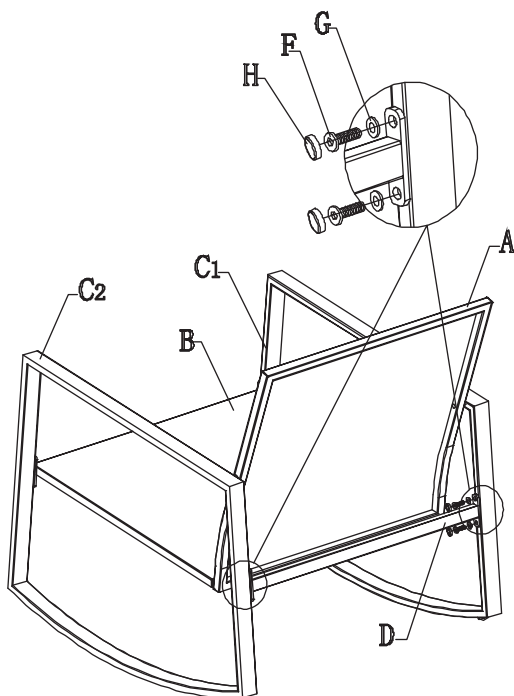

5. Complete the assembly, then secure and tighten all the screws. Finally, place the screw covers (H) over them



COFFEE TABLE

Item No.	Reference Image	Description	QTY
J		Table Top	1pc
K		Legs	2pcs
L		Leg Support	2pcs
M		Glass Top	1pc
E		M6x35 Socket Head Cap Screw	4pcs
F		M6x20 Socket Head Cap Screw	8pcs
G		Flat Washer	12pcs
H		Screw Cover	12pcs
I		4-mm Allen Key	1pc

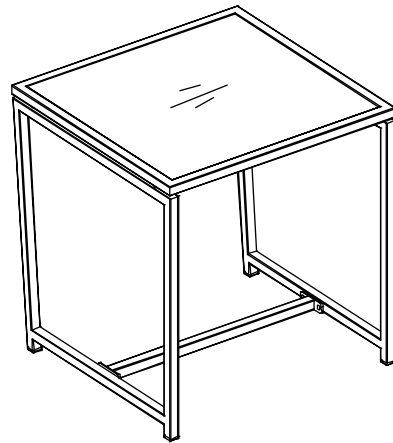

1. Flip the assembly upside down. Attach the table top (J) to the legs (K) using an M6x35 socket head cap screw (E) with a flat washer (G).

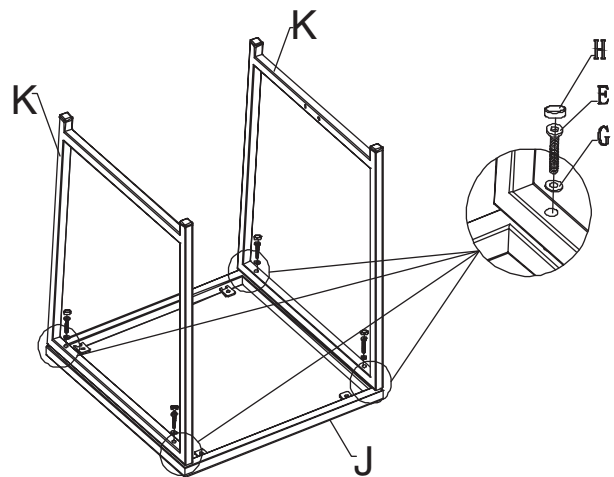

2. While the assembly is still flipped over, attach the leg supports (L) using M6x20 socket head cap screws (F) with flat washers (G) in eight locations.

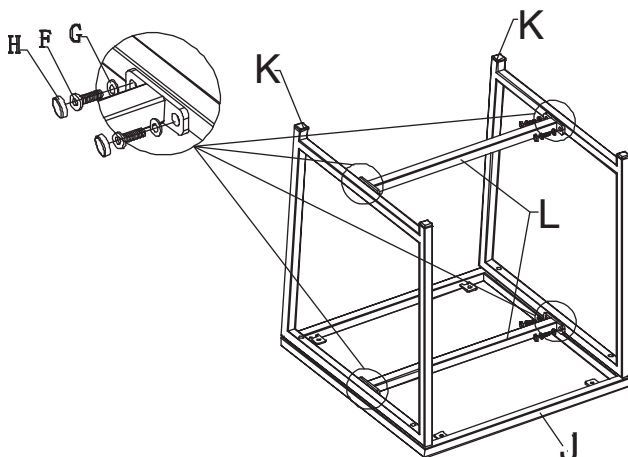



COFFEE TABLE

3. Flip the assembly back over, and then place the glass top (M) on it.

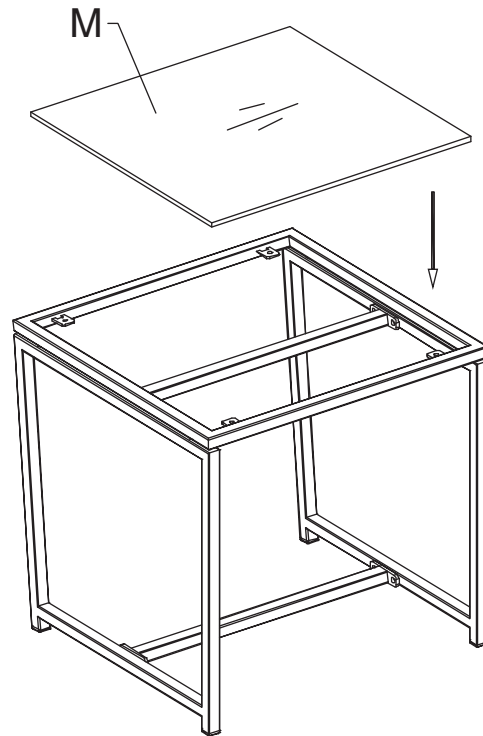

4. Complete the assembly, fix and tighten all the screws, and finally, place the screw covers (H) over them.



Enjoy Cozy Life!

SUPPORT:

Toll free : 866-355-0018

www.kozyard.com

email: support@kozyard.com

SOCIAL MEDIA:



Follow us on Instagram

www.instagram.com/kozyard

KOZYARD LLC